

SECTION A-A

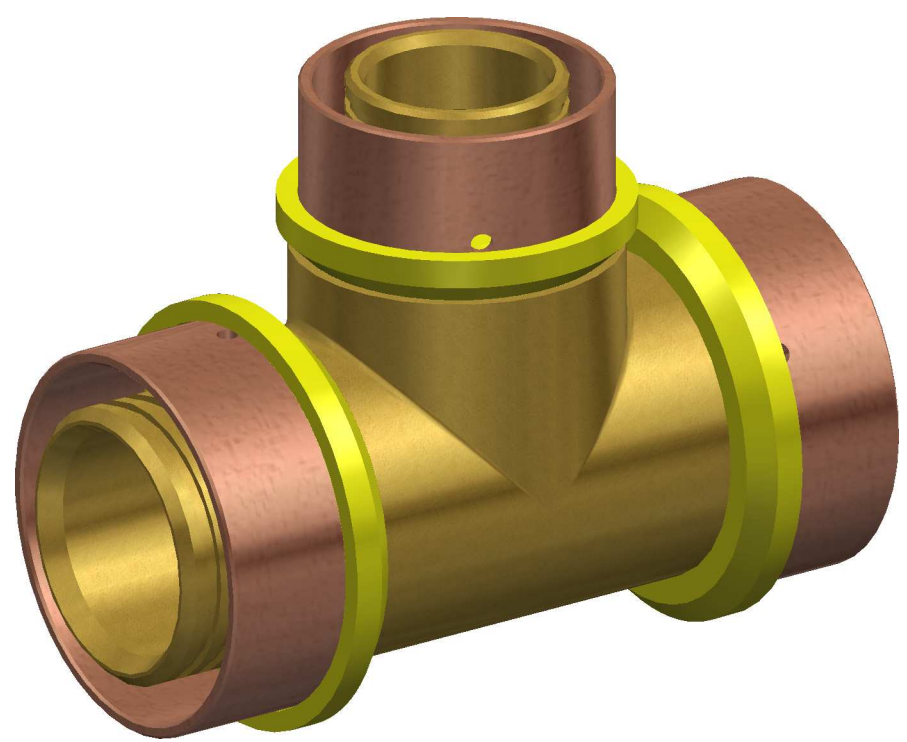

| REVISIONS | DESCRIPTION      | DATE     | APPROVED |
|-----------|------------------|----------|----------|
| A         | INITIAL RELEASE. | XX-XX-18 | M.H.     |

**UNLESS OTHERWISE STATED**  
 NOM = Nominal  
 O/A = Overall  
 TYP = Typical  
 C/O = Clear Opening  
 All measures in millimeters.

This drawing and all information contained thereon are the exclusive property of Iplex Pipelines Pty Ltd. Unless specifically noted, this drawing and items shown on this drawing are subject to change at any time and without prior notice.  
 Measures are for reference purpose only.

© IPLEX PIPELINES PTY LTD  
 1300 0 IPLEX (47539)  
 www.iplex.com.au  
 info@iplexpipelines.com.au

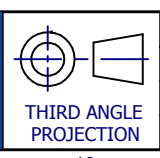

MASS: .267 kg  
 MATERIAL: BRASS  
 A3 - NTS  
 Sheet 1 of 1

DESCRIPTION: DN32 x DN25 x DN32 K1™ Gas Brass Reducing Tee  
 CODE: FK156322532  
 REV: A