

SECTION A-A

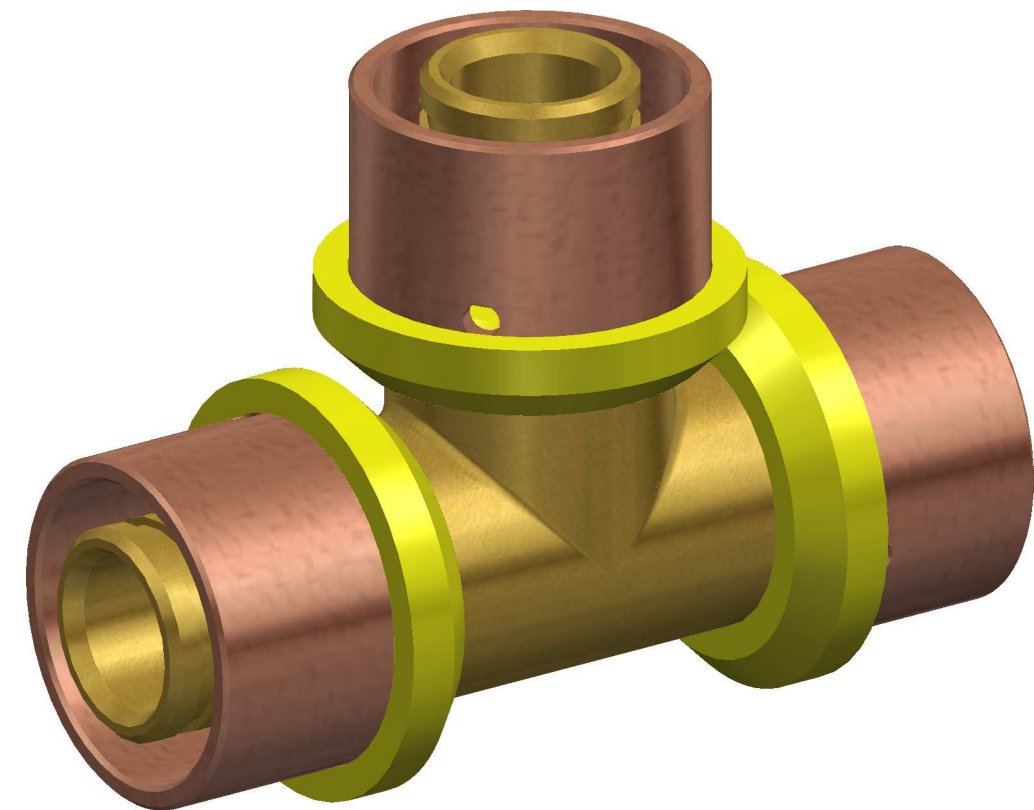

| REV | DESCRIPTION | DATE | APPROVED |
|-----|------------------|----------|----------|
| A | INITIAL RELEASE. | XX-XX-18 | M.H. |

UNLESS OTHERWISE STATED
 NOM = Nominal
 O/A = Overall
 TYP = Typical
 C/O = Clear Opening
 All measures in millimeters.

This drawing and all information contained thereon are the exclusive property of Iplex Pipelines Pty Ltd. Unless specifically noted, this drawing and items shown on this drawing are subject to change at any time and without prior notice.
 Measures are for reference purpose only.

© IPLEX PIPELINES PTY LTD
 1300 0 IPLEX (47539)
 www.iplex.com.au
 info@iplexpipelines.com.au

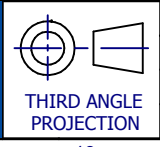

MASS: .074 kg
 MATERIAL: BRASS
 A3 - NTS
 Sheet 1 of 1

DESCRIPTION: DN16 K1™ Gas Brass Equal Tee

CODE: FK155161616

REV: A